



MK3 Racehorse

MK3 Racehorse

Standard features

On/ Off key. 3 Speeds, from a smooth canter to a full gallop. Controlled by buttons on the hand held controller. Bridle and reins included. Controller can be fixed to the shoulder.

Maximum riding weight - 100kg.

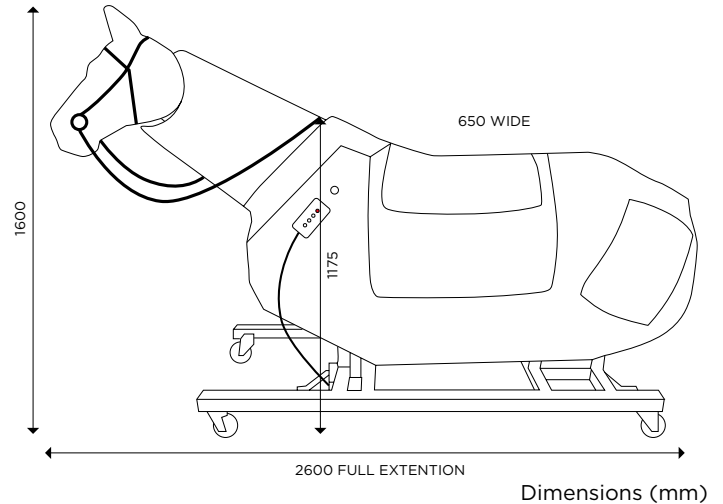
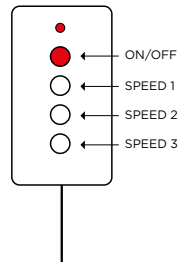

Required door width and door height

The simulator can not easily be moved up or down steps and will not bend in the middle, please consider this when you are planning the location of your simulator. Minimum door width of 700mm, door height of 1981mm and ceiling height of 2800mm required.

Floor fixing

Smooth level concrete floor recommended 1 expansion bolt drilled into floor at the front of the horse and 1 expansion bolt drilled into the floor at the rear of the horse. This simulator must be bolted to the floor prior to use.

EXPANSION BOLT

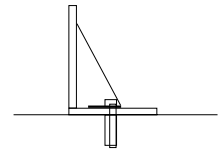

16mm x 100mm Hole

Power consumption

230V +/- 10%, 50/60Hz, 13 Amps. The simulator should be run from an individual distribution board, installed with a 30mA Residual Current Device (RCD) or Earth Leakage Circuit Breaker. Please consult with a qualified electrician. Simulator supplied with fused 13 Amp UK plug.

Location and environment

Dry, dust free environment, with no extreme variations in temperature. Temperature between -10°C and 40°C. Relative humidity <95%, free of condensation. Altitude <1000m.