

Eventing

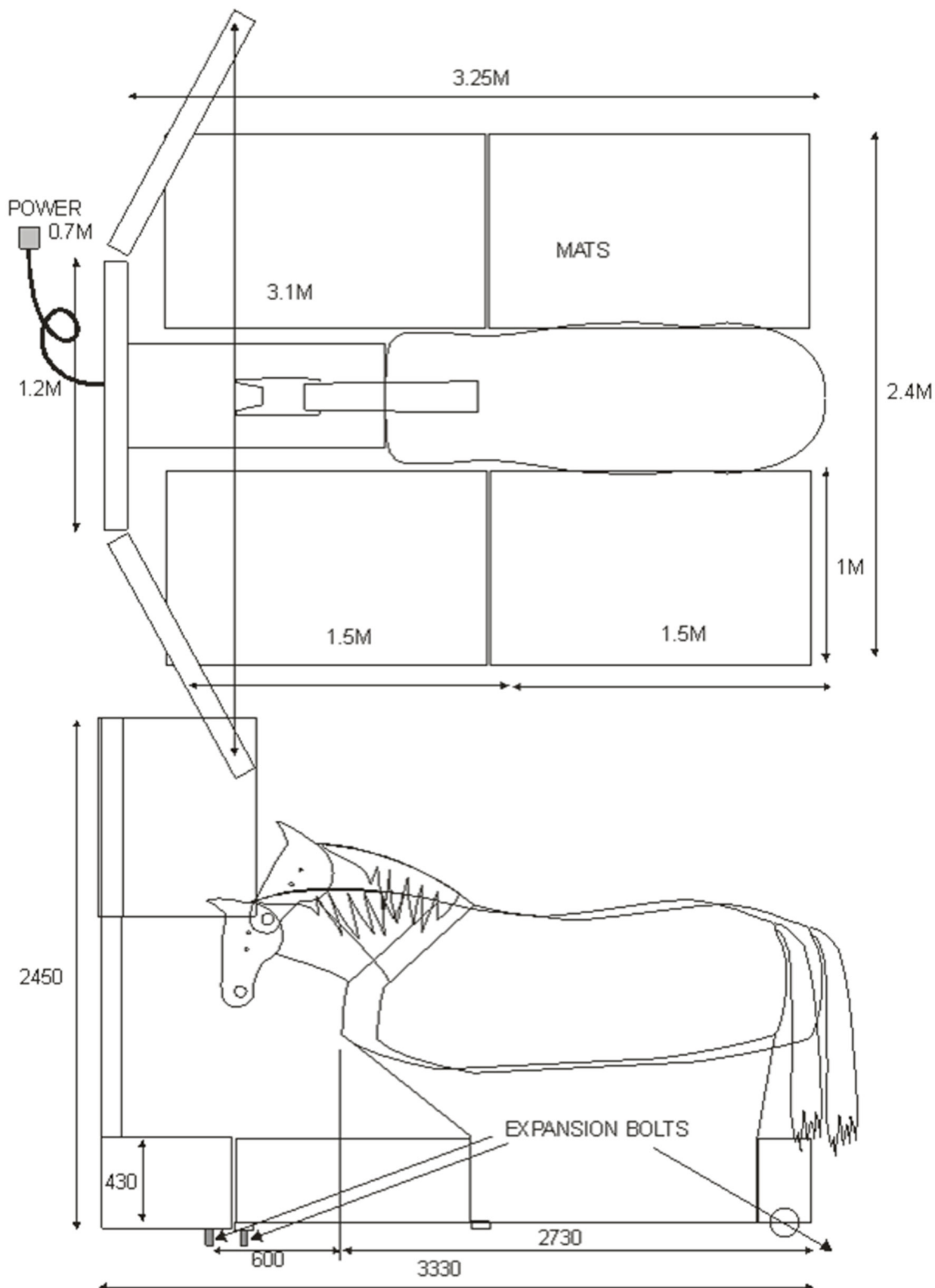

RACEWOOD
EQUESTRIAN SIMULATORS

Dimensions (mm)



Eventing



Standard Features

Realistic dressage and jumping horse in one model. Offering high level dressage movements including piaffe and passage, half pass and pirouettes. Autotraining routine showing rider position analysis from rein, seat and leg sensors showing weight and balance. Beginner, intermediate and advanced level showjumping and cross country courses. Variable height grid work to replicate jumps from 60cm up to 1.20m and practice technical cross country obstacles. Panoramic 3 screens, mounting block, 4 x mats, printer, bridle and reins included.

Optional Additions

Bespoke software
Dressage or jumping saddle
Trolley

Required door width and ceiling height

The simulator can not easily be moved up or down steps and will not bend in the middle, please consider this when you are planning the location of your simulator. Minimum door width of 700 mm and minimum ceiling height of 3000mm required. Please allow space for the surrounding safety mats.

Floor fixing

Smooth level concrete floor recommended
2 expansion bolts drilled into floor at the front and rear of the horse, and 2 expansion bolts drilled into the floor through the TV framework positioned in front of the horse. This simulator must be bolted to the floor prior to use.

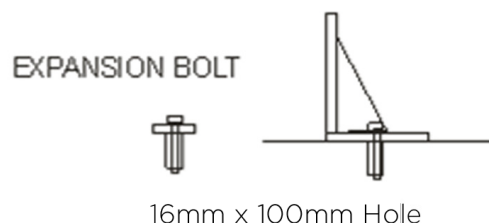

Power requirements

1 x 210 - 230v UK plug socket, 50 - 60 Hz, 13 amps. A residual current device (RCD) or an Earth Leakage Circuit Breaker must be installed in the electrical distribution system. Racewood recommend the purchase of a back up battery when operating this machine, please contact us for recommended products.

Location and environment

Dry, dust free environment, with no extreme variations in temperature.