

MK3

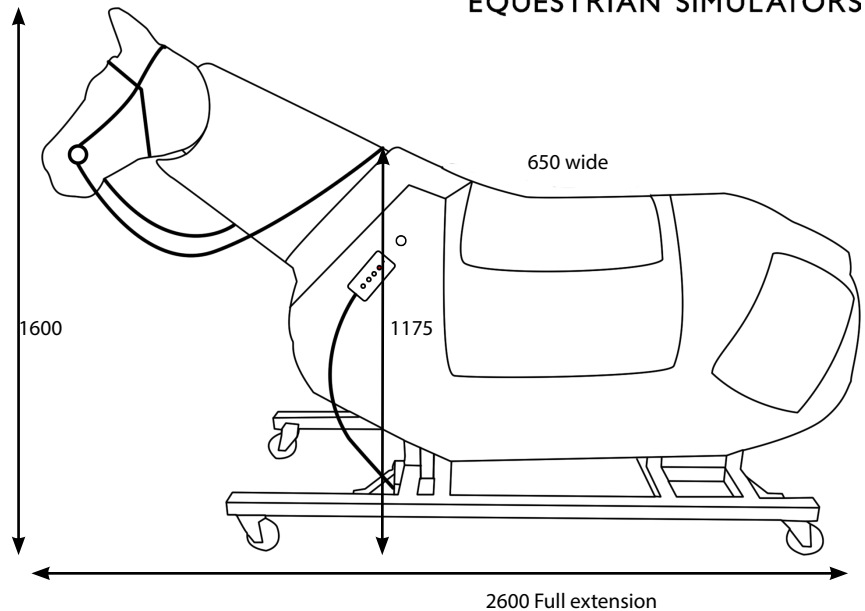

Dimensions (mm)

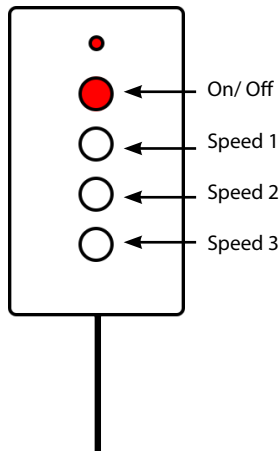

Standard Features

On/ Off button. Emergency stop. 3 Speeds, from a smooth canter to a full gallop. Controlled by detachable hand held controller on the shoulder. Whipping pad on the rear. Bridle, reins and girth included.

Required door width and ceiling height

The simulator can not easily be moved up or down steps and will not bend in the middle, please consider this when you are planning the location of your simulator. Minimum door width of 700mm and ceiling height of 2500mm required.

Floor fixing

Smooth level concrete floor recommended
1 expansion bolt drilled into floor at the front of the horse and 1 expansion bolt drilled into the floor at the rear of the horse. This simulator must be bolted to the floor prior to use.

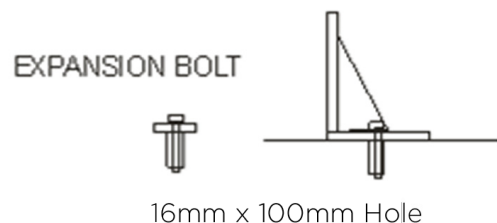

Power requirements

1 x 210 - 230v UK plug socket, 50 - 60 Hz, 13 amps. A residual current device (RCD) or an Earth Leakage Circuit Breaker must be installed in the electrical distribution system.

Location and environment

Dry, dust free environment, with no extreme variations in temperature.

Registered Office 15a Park Road Tarporley Cheshire Registered In England and Wales number 2901930. VAT No. GB 666 5574 91

info@racewood.com www.racewood.com +44 (0)1829 732 006

MADE IN BRITAIN