

# MK10

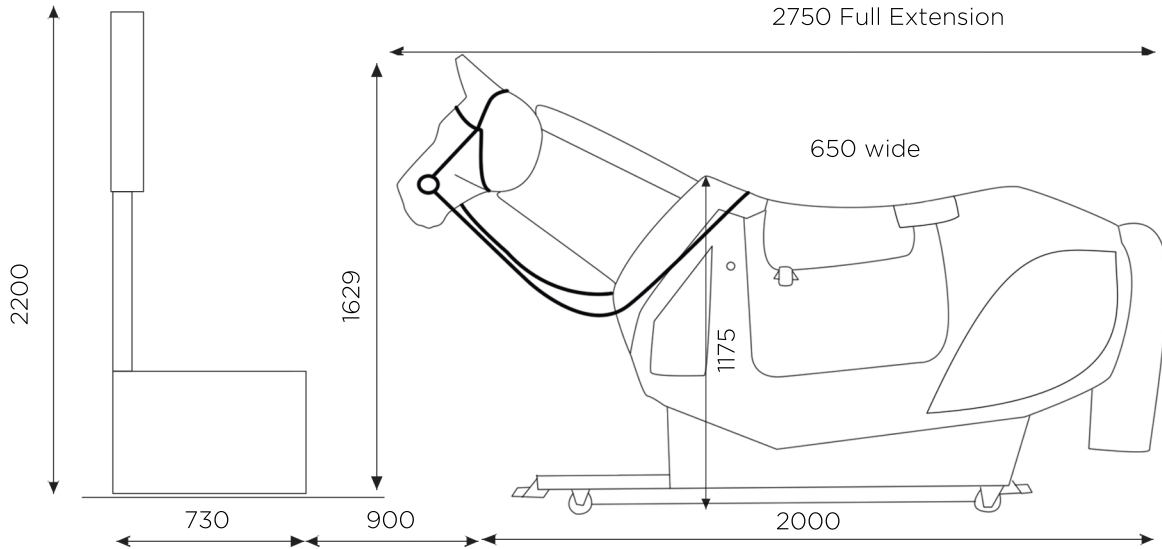

## Dimensions (mm)



## Standard features

Interactive sensor feedback shown on screen; neck pressure and rider synchronisation with the horse, reins, saddle and front and rear whipping pads. Heart rate monitor.  
Manual and autotraining routine with feedback.  
Fully interactive race simulation.  
Handheld controller.

## Optional features

Bespoke racecourse

## Required door width and ceiling height

The simulator can not easily be moved up or down steps and will not bend in the middle, please consider this when you are planning the location of your simulator. Minimum door width of 700mm and ceiling height of 2800mm required.

## Floor fixing

Smooth level concrete floor recommended, 1 expansion bolt drilled into floor at the front of the horse and 1 expansion bolt drilled into the floor at the rear of the horse. This simulator must be bolted to the floor prior to use.

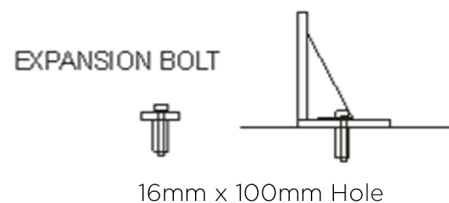

## Power requirements

210 - 230v UK plug socket, 50 - 60 Hz, 8 amps.  
A residual current device (RCD) or an Earth Leakage Circuit Breaker must be installed in the electrical distribution system.

MADE IN BRITAIN

Page 1 of 2

# MK10



## **Electrical components**

55" LED TV configured to simulator settings  
Computer connected to sim via 2 x USB cable  
Ant+ dongle and heart rate watch

## **Location and environment**

Dry, dust free environment with no extreme variations in temperature.