

Racewood
Eventing
Simulator
Saddle Sensor
Set Up Guide



RACEWOOD
EQUESTRIAN SIMULATORS

Please ensure that you read the entire document and familiarise yourself with the parts before adjusting the saddle airbags

The saddle sensors are split into 4 airbags. Front left and right (**FL, FR**) and back left and right (**BL, BR**).

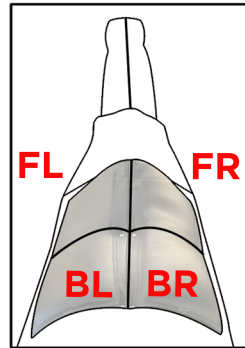

Each airbag is linked by a pipe to a connector located on the chest of the horse. As you face the horse's chest the front pipes are the inner two connections and the back are the outer two.

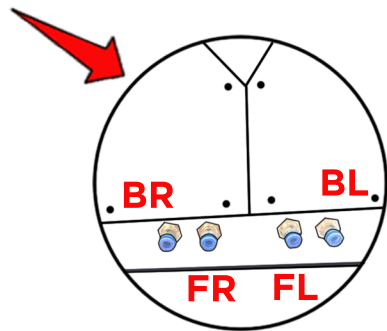

Select dressage instruction screen on the simulator

Below the centre balance circle you will see the airbag values. The front values should be equal and the back values equal.

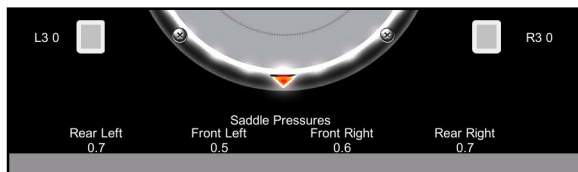

The front and back do not need to be equal. Most saddles will cause the weight to be distributed towards the back.

The variation between the front and back sensors is personal preference.

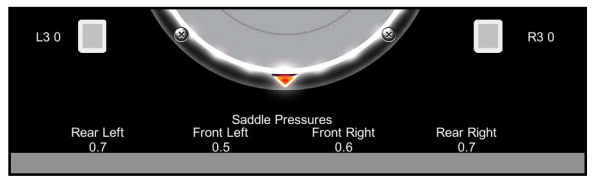

If you require a more central representation of the rider's weight you may need to add more air to the front air bags to compensate for the weight of the saddle.

Adjusting the saddle sensors

To inflate

Insert the black pipe into the appropriate connecting point. The air values on screen will increase as air is pumped in.

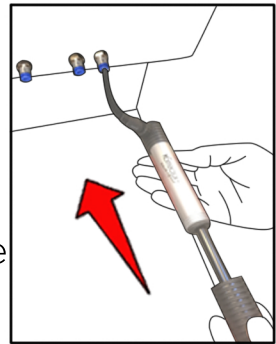

To deflate

Insert the short black tube into the connecting point, ensuring a secure connection is made so that air can escape. The air value on screen will decrease as air is removed.

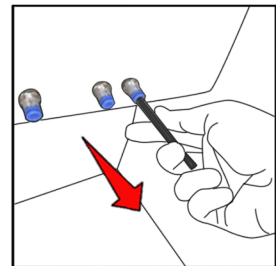

To remove the pipe

Push in the outer blue rim of the connection with one hand and remove the tube with the other.

It is important that you remove the saddle at the end of every day and check the air bag values at the start of every session. Become familiar with these steps so that you can adjust the saddle sensors regularly.



MADE IN BRITAIN 

Registered Office 15a Park Road Tarporley Cheshire Registered In England and Wales
number 2901930. VAT No. GB 666 5574 91